

FA30V Advance / FA30V Advance (Z600 specifications)

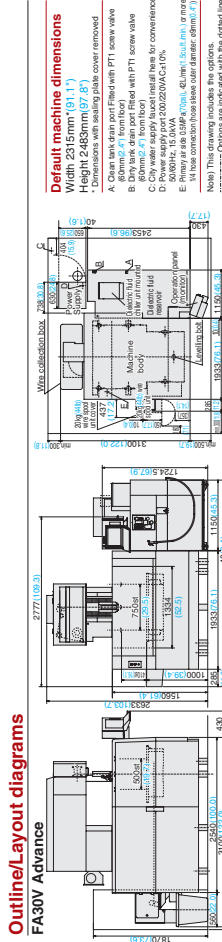

FA30V Advance



FA30V Advance (Z600 specifications)

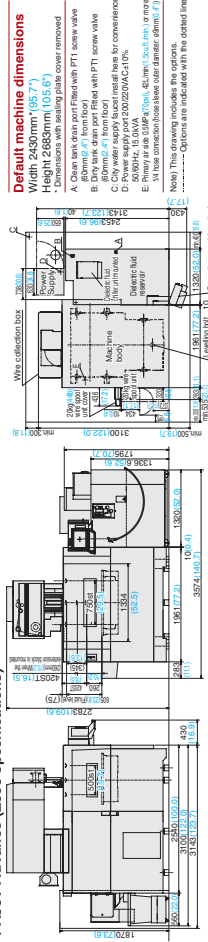
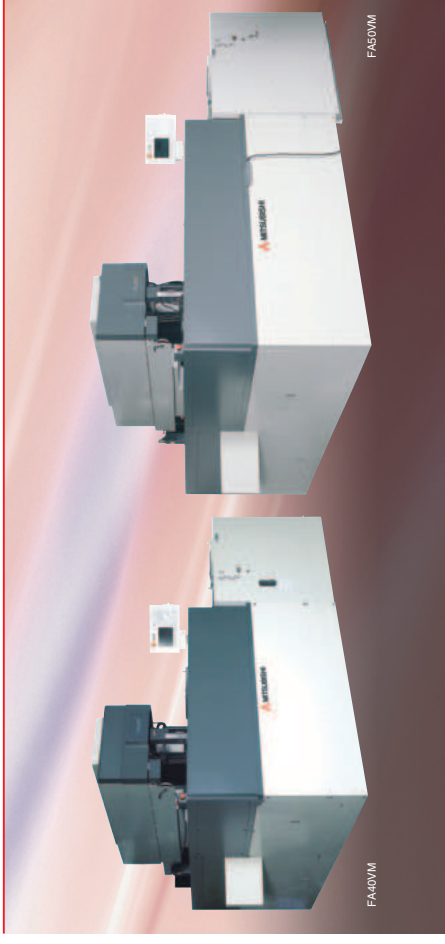

Table diagram

Machine unit	FA30V ADVANCE	FA30V ADVANCE (Z600 specifications)
Model	FA30V	FA30VZ
Maximum workpiece dimensions (WxDxH)	[mm] (in) 1300 (51.2) x 1000 (39.4) x 605 (23.8)	1300 (51.2) x 1000 (39.4) x 605 (23.8)
Maximum workpiece weight	[kg] (lb) 3000 (661.3)	3000 (661.3)
Mechanical travel (X-Y-Z)	[mm] (in) 1100 (43.3) x 875 (34.4)	1100 (43.3) x 875 (34.4)
Mechanical travel (X-Y-Z)	[mm] (in) 750 (29.5) x 500 (19.7) x 101 (4.0)	750 (29.5) x 500 (19.7) x 200 (7.9)
Max. taper angle	[°] 100 (53.9) x 100 (53.9)	15 (7.95mm) (4.0)
Wire diameter	[mm] (in) 0.2 (0.008) to 0.3 (0.012) *	0.2 (0.008) to 0.3 (0.012) *
Weight	[kg] (lb) 9000 (11,000)	5700 (25,866)
Dielectric fluid reservoir	[L] [US gal] 1360 (359)	1700 (449)
Filtration method	Paper filter (four)	Paper filter (four)
Filtered particle size	[µm]	3
Water purifier (ion exchange resin)	[L] [cu.ft.] 20 (0.7)	20 (0.7)
Unit cooler	[kg] (lb) 550 (121.0)	560 (127.8)
General input	[kVA]	15.0
Required air	[Mpa] (psi) 0.5 to 0.7 (7.0 to 10.0)	0.5 to 0.7 (7.0 to 10.0)
Fluid rate	[L] [cu.ft./min] 42 (1.5) or more	42 (1.5) or more

Main options
 Wire processing unit
 20kg (44lb) wire spool unit specifications
 4-φ (1.6in) filter
 Advanced manual operation box

FA40VM / FA50VM



FA40VM

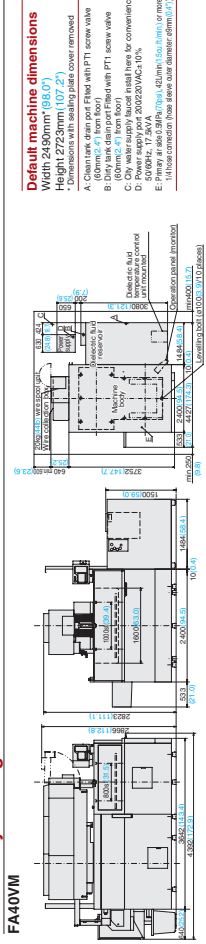

FA50VM

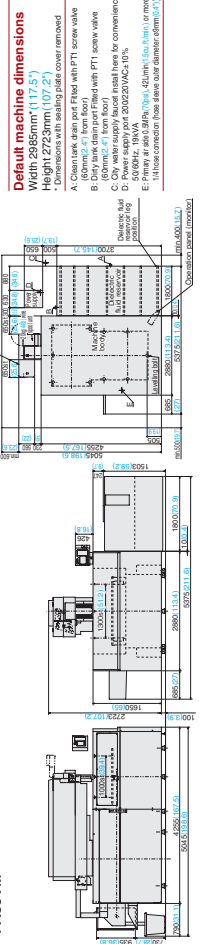

Table diagram

Machine unit	FA40VM	FA50VM
Model	FA40VM	FA50VM
Maximum workpiece dimensions (WxDxH)	[mm] (in) 1550 (61.0) x 1300 (51.2) x 395 (15.6)	2000 (78.7) x 1600 (63.0) x 395 (15.6)
Maximum workpiece weight	[kg] (lb) 4000 (881.8)	4000 (881.8)
Mechanical travel (X-Y-Z)	[mm] (in) 1360 (53.5) x 1175 (46.3)	1660 (65.4) x 1275 (50.1)
Mechanical travel (X-Y-Z)	[mm] (in) 1000 (39.4) x 800 (31.5) x 400 (15.7)	1000 (39.4) x 1000 (39.4) x 400 (15.7)
Max. taper angle	[°] 75 (40.0) x 75 (40.0)	75 (40.0) x 75 (40.0)
Wire diameter	[mm] (in) 0.2 (0.008) to 0.3 (0.012) *	0.2 (0.008) to 0.3 (0.012) *
Weight	[kg] (lb) 11000 (24,200)	10000 (22,000)
Dielectric fluid reservoir	[L] [US gal] 2425 (640)	3200 (845)
Filtration method	Paper filter (four)	Paper filter (four)
Filtered particle size	[µm]	3
Water purifier (ion exchange resin)	[L] [cu.ft.] 20 (0.7)	20 (0.7)
Unit cooler	[kg] (lb) 680 (150.0)	1000 (220.5)
General input	[kVA]	17.5
Required air	[Mpa] (psi) 0.5 to 0.7 (7.0 to 10.0)	0.5 to 0.7 (7.0 to 10.0)
Fluid rate	[L] [cu.ft./min] 42 (1.5) or more	42 (1.5) or more

Main options
 50kg (110lb) wire spool unit